

201 SERIES OPERATING INSTRUCTIONS

Operating Instructions:

1. Insert connector onto test piece. Make sure a minimum of .560 of engagement is achieved. This will ensure proper seal life and gripping ability.



2. Cam the handle 90°.



3. Introduce test media through the 1/8" NPT charge port.



4. After your test is completed, vent the system then remove connector.

Adjustment:

1. If the RAMSEAL® connector is not sealing properly some adjustment may be needed.
2. The adjusting nut and body are set using Loctite® from the factory. Uses a 3/4" wrench to break the Loctite® loose.
3. Counterclockwise to tighten.



4. Clockwise to loosen.



Replacement Parts and Assembly Diagram:

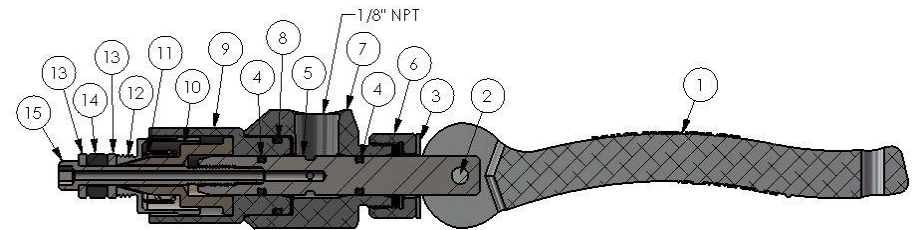

ITEM NO.	MODEL 201	DESCRIPTION
1	20102	Handle
2	20103	Handle Pin
3	20112	Wear Washer
4	20124	Quad Seal (Shaft)
5	20128	Shaft
6	20131	Adjusting Nut
7	20101	Body
8	20123	Quad Seal (Guard)
9	20127	Guard
10	20122	Collet Operator
11	20107	Spring
12	20106-*	Collet
13	20115-*	Seal Stop
14	20108-*	Seal
15	20117	Seal Screw

*Specify Model Number, and /or Tube I.D. and O.D.