

# 141-142 SERIES OPERATING INSTRUCTIONS

## Operating Instructions:

1. Insert connector onto test piece. Make sure a minimum of .360 of engagement is achieved. This will ensure proper seal life and gripping ability.



2. Cam the handle 90°.



3. Introduce test media through the 1/8" NPT charge port.



4. After your test is completed vent the system then remove connector.

## Adjustment:

1. If the RAMSEAL® connector is not sealing properly some adjustment may be needed.
2. The adjusting nut and body are set using Loctite® from the factory. Uses a 3/4" wrench to break the Loctite® loose.
3. Counterclockwise to tighten



4. Clockwise to loosen.



## Replacement Parts and Assembly Diagram:

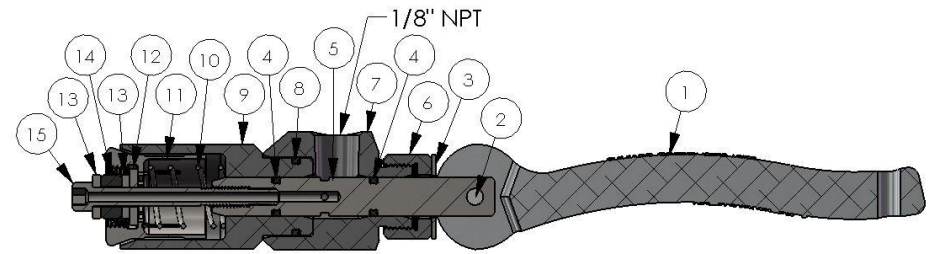

ITEM NO.	MODEL 141	MODEL 142	DESCRIPTION
1	14102	14202	Handle
2	14103	14203	Handle Pin
3	14112	14212	Wear Washer
4	14124	14224	Quad Seal (Shaft)
5	14128	14228	Shaft
6	14131	14231	Adjusting Nut
7	14101	14201	Body
8	14123	14223	Quad Seal (Collet Operator)
9	14122	14222	Collet Operator
10	14107	14207	Spring
11	14106-*	14206-*	Collet
12	14115-*	14215-*	Tube Stop
13	14115-*	14215-*	Seal Stop
14	14108-*	14208-*	Seal
15	14117	14217	Seal Screw

\*Specify Model Number, and /or Tube I.D. and O.D.